

# Installation Guide sealing system

 Always apply sealing tape prior to installation of attic hatch!

## 1 Glue sealing tape in place:

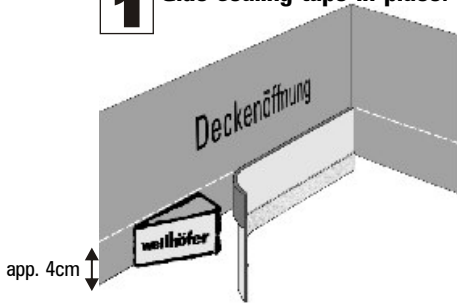

Cut off in corners and re-apply.

## 3 Push in insulation braid:

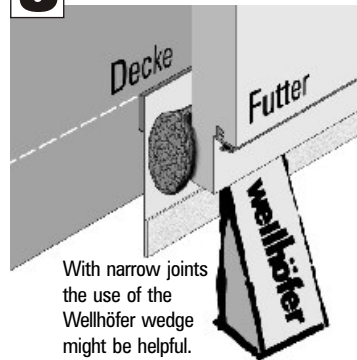

With narrow joints the use of the Wellhöfer wedge might be helpful.

Cut off in corners and re-apply. For close connection upset joints in the corners.

## 4 Closing of joint:

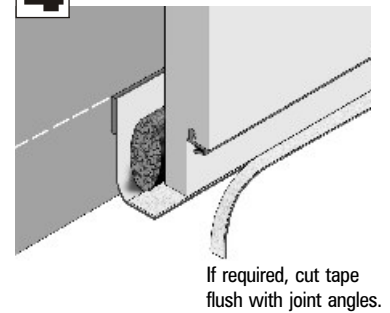

If required, cut tape flush with joint angles.

Glue sealing tape to lining bar all over.

## 2 Install attic hatch (see Installation Guide attic hatch)

## 5 Install architraves (see Installation Guide architraves)

Full effect is gained only if the sealing system has been implemented as described above.

**wellhöfer**  
 TREPPEN AUS WÜRZBURG

## The looks of an airtight installation:

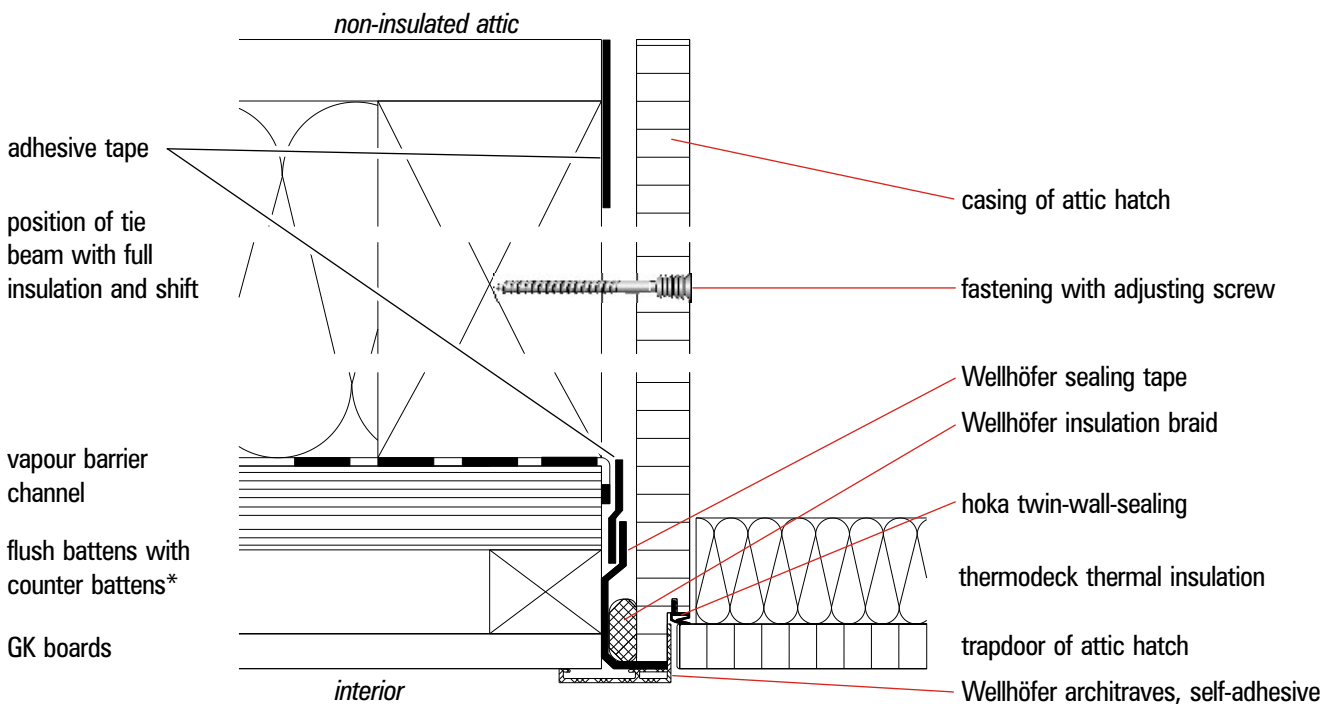

\*If battens are not flush, the adhesive strip must be securely glued to the shift. The Wellhöfer sealing tape should not be glued onto the battens but tightly and securely onto the first adhesive tape.

**wellhöfer**  
 TREPPEN AUS WÜRZBURG