

PRODUCT APPLICATIONS

The best wood fibre insulation for
roofs, walls and interiors



TABLE OF CONTENTS

1. Product Overview	P. 4
Ecological wood fibre insulation for new and refurbished buildings – From roof to cellar ceiling	P. 4
Applications and Solutions	P. 6
Roofs	P. 7
Walls	P. 8
Interior	P. 9
Technical Information	P. 10
Multitplex-top®	P. 10
Ultratherm®	P. 10
Thermosafe-homogen®	P. 10
Thermofibre®	P. 13
Thermoflex®	P. 13
Thermoflat®	P. 13
Multitherm®	P. 13
Thermoinstal®	P. 13
Thermoroom®	P. 14
Thermosafe-wd®	P. 14
Thermosafe-nf®	P. 14
Thermofloor®	P. 14
Happy Step®	P. 14
Standard-n®	P. 14
Thermowall®	P. 16
Thermowall® NF	P. 16
Thermowall®-gf	P. 16
Thermowall®-L	P. 18
Pyroresist® wall	P. 18

PRODUCT OVERVIEW

Ecological Wood Fibre Insulation for New and Refurbished Buildings - From Roof to Cellar Ceiling

GUTEX ecological insulation products are the ideal choice for a host of applications, including external thermal insulation composite systems, wall insulation for vented facades (rainscreens), insulation above rafters and/or between frame members with rain-tight sheathing, insulation of ceilings, interior insulation of exterior walls, insulation of service cavities, acoustic underlay in various floor assemblies and under many floor coverings. We source the raw material for our manufactured products from fir and spruce grown and harvested using solely sustainable forestry practices. The products conform to the highest quality standards and their KEYMARK certification mark confirms their compliance with all applicable EU standards.



GUTEX Multiplex-top®
Certified rain-tight sarking board.



GUTEX Ultratherm®
Unique rain-tight sarking board with patented tongue and groove interlocking system and an excellent U-factor.



GUTEX Multitherm®
Moisture-resistant insulation board for rainscreen applications, supplemental above-rafter roof sarking or under-rafter insulation.



GUTEX Thermosafe-homogen®
Universal wood fibre insulation board with excellent insulation properties for roofs and exterior walls.



GUTEX Thermofibre®
Wood fibre blow-in insulation for enclosed cavities or as loose fill in unenclosed horizontal spaces.



GUTEX Thermoflex®
Flexible wood fibre batt for use between rafters and cavities.



GUTEX Thermoflat®
Compression-resistant wood fibre insulation board for flat roofs with wood, concrete or sheet metal construction.



GUTEX Thermoinstal®
Compression-resistant insulation for service cavities.



GUTEX Thermoroom®
Wood fibre insulation board for the interior insulation of exterior walls.



GUTEX Thermosafe-wd®
Compression-resistant insulation for interior floors and walls.



GUTEX Thermosafe-nf®
Impact insulation board with spruce joint strips for screw-fastened solid wood floor planking and short plank wood flooring.



GUTEX Thermofloor®
Impact insulation board for all floor assemblies.

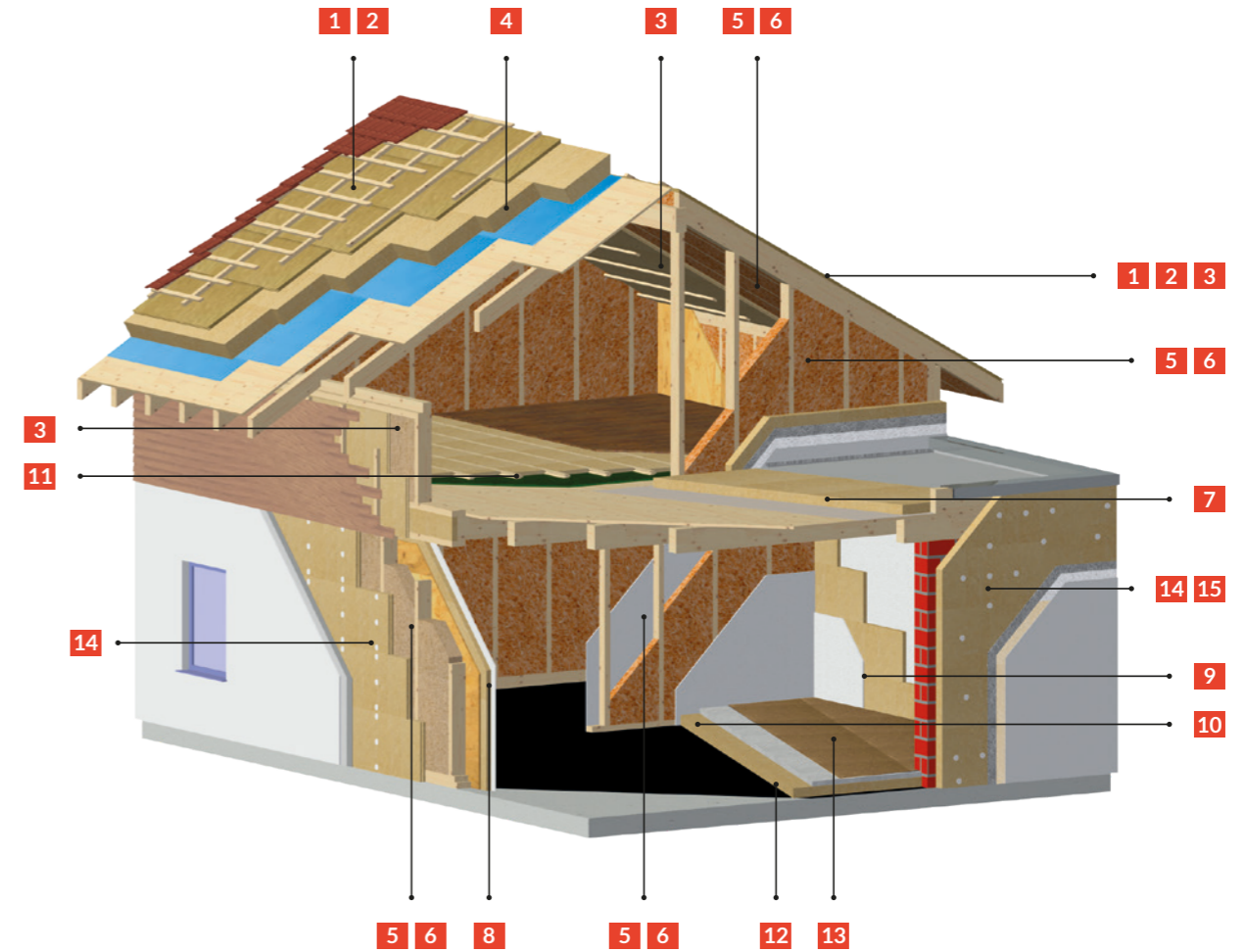

GUTEX Happy Step®
Underlay softens the impact of footfall for more pleasant walking and quieter floors, such as wood planking.



GUTEX Thermowall®-gf /NF
Plasterboard for the ecological Thermowall® ETICS.



GUTEX Thermowall®-L
Lighter plasterboard delivers superb insulation with the ecological Thermowall® ETICS. Particularly ideal for installation over uninterrupted masonry or wood substrates.



GUTEX Thermowall® Durio
Specifically designed board for use in Durio® facade systems finished in render and timber rainscreens.

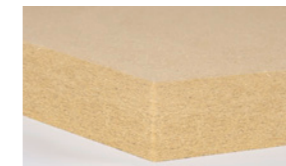

GUTEX Pyroresist® wall
Ignition-resistant wood fibre insulation board for exterior walls subject to higher fire code rating standards.

NOTE

You'll find more information about properly using our insulation products at:

www.gutex.de

APPLICATIONS AND SOLUTIONS



Roofs

- › **Tecadio® GUTEX roof refurbishment system**
- › Above-rafter insulation
- › Sarking boards
- › Flat roof insulation
- › Cavity insulation (GUTEX Thermoflex® batts)
- › Cavity insulation (GUTEX Thermofibre® blow-in insulation)

Interior

- › **Intevio® GUTEX interior insulation system**
- › Vapour permeable underlay installed from interior between rafters
- › Rafter underside insulation boards
- › Insulation under screed (dry / wet)
- › Top storey ceiling
- › Suspended ceiling
- › Solid wood flooring / Solid wood plank flooring
- › Service cavity insulation course
- › Partition walls
- › Cavity insulation (GUTEX Thermoflex® batts)
- › Cavity insulation (GUTEX Thermofibre® blow-in insulation)

Exterior Walls

- › **Thermowall® ETICS external thermal insulation composite system**
- › Render
- › Rainscreen
- › Brick facing
- › **Durio® system for unique facade design**
- › **Implio® window integration system**
- › Cavity insulation (GUTEX Thermoflex® batts)
- › Cavity insulation (GUTEX Thermofibre® blow-in insulation)

ROOFS

Protection against heat, cold and dependable resistance against rain

With GUTEX insulation products, your house or building stands secure against the elements. Our sarking boards are not just rain-tight, but as per TÜV Rheinland, they're hail-safe. And our insulation products deliver dependable protection against cold and excellent insulation against heat thanks to their lower thermal conductivity and greater volumetric thermal capacity. Significant diffusion openness, moisture absorption and release capacities ensure built structures and materials remain sound and healthy. High compression resistance and superb bend (flexural) strength mean the insulation products are stronger and more resistant to impact, making them more durable in the hands of contractors. Moreover, the durability and consistent dimensional trueness speed up their installation. Nail tape or strip sealant products are not required to seal temporarily exposed roofs. Such roofs remain weatherproof for up to twelve weeks.



GUTEX Multiplex-top®



GUTEX Ultratherm®



GUTEX Thermofibre®

ADVANTAGES

- › Sarking and sheathing boards with patented tongue and groove joints deliver dependable protection against rain and superb durability
- › TÜV-certified hail protection (Hagelschutzklasse HW5)
- › Cross-brand cooperation between system designers, e.g. manufacturers of membranes, vapour barriers and adhesives
- › Seminars for system knowledge transfer

Systems and Products

- › **Tecadio® GUTEX roof refurbishment system**
- › GUTEX Ultratherm® rain-tight sarking board
- › GUTEX Multiplex-top® rain-tight sarking board
- › GUTEX Thermosafe-homogen® universal insulating board with homogenous cross-section
- › GUTEX Multitherm® moisture-resistant insulation board
- › GUTEX Thermoflex® flexible wood fibre insulation batt
- › GUTEX Thermofibre® blow-in insulation

WALLS

Energy efficiency, comfort, wholesome living

Building with GUTEX systems and products to insulate exterior walls allows you to build compliant with energy efficiency standards, such as those stipulated by the KfW ("Effizienzhaus") in Germany, that may qualify you for rebates, preferred mortgage rates, etc. In addition, you have the assurance that your home will be comfortable and healthy. GUTEX Thermowall® is the ETICS product for wood and masonry structures, while Durio® provides you with the greatest design freedom. Implio® gives you the assurance that your windows integrate tightly and effectively in your building's ETICS. And you may like to know that our wood fibre insulation boards are highly suitable in rainscreens installed on masonry, solid wood or timber-framed structures.



ADVANTAGES

- › Thermowall® ETICS' certification offers you the freedom of choosing render systems from 13 different manufacturers
- › ETICS installs directly to timber framing
- › Very diffusion-open insulation, which provides long-lasting integrity and performance
- › Cross-brand cooperation between system partners, e.g. manufacturers of render
- › Greater transparency and dependability in planning and installation thanks to the available 340 certified wood construction designs

Systems and Products

- › **Thermowall® ETICS**
external thermal insulation composite system
- › **Durio® system for unique facade design**
- › **Implio® window integration system**
- › GUTEX Multitherm® moisture-resistant insulation board
- › GUTEX Thermoflex® flexible wood fibre insulation batt
- › GUTEX Thermofibre® blow-in Insulation



GUTEX Thermoflex®



GUTEX Thermofibre®



GUTEX Thermowall®/-gf



GUTEX Thermowall®-L



GUTEX Thermowall® Durio

INTERIOR

Improved thermal insulation, effective acoustic insulation and comfortable living spaces

Intevio® interior insulation system installs easily and quickly, and provides dependable protection against mould and mildew. Thanks to lower costs and higher energy savings, the expense of refurbishment quickly pays for itself with this system. GUTEX insulation floorboards are suitable for use over concrete and in wooden joist ceiling constructions, as well as a host of different assemblies, delivering very good acoustic insulation, for example, under wet screed, mastic asphalt, particle or chipboard, OSB substrate floorboards, dry screed, engineered wood flooring, laminate flooring and solid wood planking. Application-specific solutions are also available for service cavities and light-weight partition walls.



ADVANTAGES

- › Moisture-resistant interior insulation
- › Highly effective insulation against impact and airborne noise
- › Many available certified and quantified acoustic insulation assemblies
- › Floor insulation with excellent impact resistance and good thermal conductivity performance

Systems and Products

- › **Intevio® GUTEX interior insulation system**
- › GUTEX Thermosafe-homogen® universal insulating board with homogenous cross-section
- › GUTEX Thermosafe®-nf
- › GUTEX Thermosafe-wd® compression-resistant insulation for interior floors and walls
- › GUTEX Happy Step®, a universal underlay for high-quality interior floor coverings
- › GUTEX Thermoroom®, specially designed to insulate interior sides of outer walls
- › GUTEX Thermoflex® flexible wood fibre insulation batt
- › GUTEX Thermofibre® blow-in insulation
- › GUTEX Thermostat® compression-resistant insulation for service cavities
- › GUTEX Thermofloor® versatile impact insulation board



GUTEX Multitherm®



GUTEX Thermoroom®



GUTEX Thermoflex®



GUTEX Thermosafe-wd®



GUTEX Thermostat®

Product	Multitplex-top®			Ultratherm®							Thermosafe-homogen®										
Joint Type	Tongue and Groove			Tongue and Groove							Butt					Rebate					
	DIN EN 13171			DIN EN 13171							DIN EN 13171										
Thickness (mm)	22	28	35	50	60	80	100	120	140	160	40	60	80	100	120	140	160	180	200	220	240
Length x width (mm)	2500 x 750			1780 x 600							1200 x 625										
Weight per sheet (kg)	8.25	10.5	13.12	9.6	11.5	15.4	19.2	23.1	26.9	30.8	3.3	4.95	6.6	8.25	9.9	11.55	13.2	14.85	16.5	18.15	19.8
Weight per m ² (kg)	4.4	5.6	7.0	9.0	10.8	14.4	18	21.6	25.2	28.8	4.4	6.6	8.8	11	13.2	15.4	17.6	19.8	22	24.2	26.4
Boards per pallet	45	35	28	40	36	26	20	18	14	12	112	70	56	42	36	32	28	24	22	20	18
Square metres per pallet (m ²)	84.38	65.63	52.50	42.72	38.44	27.77	21.36	19.22	14.95	12.82	84	52.5	42	31.5	27	24	21	18	16.5	15	13.5
Actual coverage, length x width (mm)	2480 x 728		2480 x 722	1749 x 569 (0.995 m ²)												1185 x 610					
Square metres per sheet (m ²)	1.875			1.07							0.75										
Weight per pallet (kg)	430			430	445	430		400			430	390									
Density (kg/m ³)	~ 200			~ 180							~ 110										
Nominal thermal resistivity R _D (m ² K/W)	0.50	0.60	0.75	1.15	1.40	1.90	2.35	2.85	3.30	3.80	1.05	1.55	2.10	2.60	3.15	3.65	4.20	4.70	5.25	5.75	6.30
Thermal resistivity R (m ² K/W)	0.45	0.60	0.70	1.10	1.35	1.80	2.25	2.70	3.15	3.60	1.00	1.50	2.00	2.50	3.00	3.50	4.00	4.50	5.00	5.50	6.00
sd-value (m)	0.066	0.084	0.105	0.15	0.18	0.24	0.30	0.36	0.42	0.48	0.16	0.24	0.32	0.40	0.48	0.56	0.64	0.72	0.80	0.88	0.96
Vapour diffusion factor (μ)	3			3							4										
Specific heat capacity (J/kgK)	2100			2100							2100										
Nominal thermal conductivity λ _D (W/mK)	0.044			0.042							0.038										
Thermal conductivity λ̄ (W/mK) as per German reg.	0.046			0.044							0.040										
Compressive stress/ strength (kPa)	200			150							50										
Tensile strength perpendicular to board surface (kPa)	30			20							5										
Short-term water absorption (kg/m ²)	≤ 1			≤ 1							≤ 2										
Dynamic stiffness (MN/m)																					
Compressibility (mm)																					
Air flow resistivity (kPa·s/m ²)	100			100							100										
Fire reaction ¹⁾	E			E							E										

Product	Thermofibre®		Thermoflex®												Thermoflat®				Multitherm®										Thermoinstal®	
Joint Type	Unenclosed	Enclosed (cavities)	Butt												Rebate				Tongue and Groove										Butt	Butt
	ETA-12/0181		DIN EN 13171												DIN EN 13171				DIN EN 13171										DIN EN 13171	
Thickness (mm)	Bale length 330		30	40	50	60	80	100	120	140	160	180	200	220	240	100	120	140	160	40	60	80	100	120	140	160	180	200	60	50
Length x width (mm)	Bale dimensions 800 x 400		1350 x 575												1230 x 600				1760 x 600										3000 x 1250	1250 x 600
Weight per sheet (kg)	15 kg (per bale)		1.16	1.55	1.94	2.33	3.11	3.88	4.66	5.43	6.21	6.99	7.76	8.54	9.32	10.3	12.4	14.5	16.5	5.92	8.87	11.83	14.78	17.74	20.70	23.66	26.61	29.57	31.50	5.6
Weight per m ² (kg)			1.5	2	2.5	3	4	5	6	7	8	9	10	11	12	14	16.8	19.6	22.4	5.6	8.4	11.2	14	16.8	19.6	22.4	25.2	28	8.40	7.5
Boards per pallet	21 bales (packages) per pallet		144	112	90	80	60	48	40	32	30	24	24	20	20	44	36	32	28	54	36	26	22	18	16	14	12	10	15	84
Square metres per pallet (m ²)			111.78	86.94	69.86	62.10	46.58	37.26	31.05	24.84	23.29	18.63	18.63	15.53	15.53	32.47	26.57	23.62	20.66	57.02	38.02	27.46	23.23	19.00	16.89	14.78	12.67	10.56	56.25	63
Actual coverage, length x width (mm)															1215 x 585				1740 x 580											
Square metres per sheet (m ²)			0.78												0.738				1.056										3.75	0.75
Weight per pallet (kg)	330		200												490				350										520	500
Density (kg/m ³)	25-30	29-45	~50												~140				~140											~150
Nominal thermal resistivity R _D (m ² K/W)			0.80	1.10	1.35	1.65	2.20	2.75	3.30	3.85	4.40	5.00	5.55	6.10	6.65	2.50	3.00	3.50	4.00	1.00	1.50	2.05	2.55	3.05	3.55	4.10	4.60	5.10	1.50	1.25
Thermal resistivity R (m ² K/W)			0.75	1.05	1.30	1.55	2.10	2.60	3.15	3.65	4.20	4.70	5.25	5.75	6.30	2.35	2.85	3.30	3.80	0.95	1.40	1.90	2.35	2.85	3.30	3.80	4.25	4.75	1.40	1.15
sd-value (m)			0.06	0.08	0.10	0.12	0.16	0.20	0.24	0.28	0.32	0.36	0.40	0.44	0.48	0.30	0.36	0.42	0.48	0.16	0.24	0.32	0.40	0.48	0.56	0.64	0.72	0.80	0.24	0.15
Vapour diffusion factor (μ)	1/2		1/2												3				4										3	
Specific heat capacity (J/kgK)	2100		2100												2100				2100										2100	
Nominal thermal conductivity λ _D (W/mK)	0.038		0.036												0.040				0.040										0.040	
Thermal conductivity λ (W/mK) as per German reg.	0.040		0.038												0.042				0.042										0.042	
Compressive stress/ strength (kPa)															70				70										100	
Tensile strength perpendicular to board surface (kPa)															7.5				7.5										10	
Short-term water absorption (kg/m ²)															≤ 1				≤ 2											
Dynamic stiffness (MN/m)																														
Compressibility (mm)																														
Air flow resistivity (kPa·s/m ²)	≥ 5		5												100				100										100	
Fire reaction 1)	E		E												E				E										E	

Product	Thermoroom®						Thermosafe-wd®						Thermosafe-nf®	Thermofloor®		Happy Step®	Standard-n®	
Joint Type	Butt						Butt						Tongue and Groove	Butt		Butt	Butt	
	DIN EN 13171						DIN EN 13171						DIN EN 13171	DIN EN 13171		DIN EN 13171	DIN EN 13171	
Thickness (mm)	20	40	50	60	80	100	20	30	40	60	80	100	120	41	21	31	6	6-18
Length x width (mm)	1200 x 500						1250 x 600						1190 x 380	1200 x 600		860 x 590	2500 ²⁾ x 1000	
Weight per sheet (kg)	1.6	3.1	3.9	4.7	6.2	7.8	2.1	3.2	4.2	6.3	8.4	10.5	12.6	2.41	2.4	3.6	0.8	3.8-11.3
Weight per m ² (kg)	2.6	5.2	6.5	7.8	10.4	13	2.8	4.2	5.6	8.4	11.2	14	16.8	5.3	3.4	5	1.56	1.5-4.5
Boards per pallet	96	48	36	30	24	18	224	140	112	70	56	42	36	75	180	120	640	170-55
Square metres per pallet (m ²)	57.60	28.80	21.60	18.00	14.40	10.80	168	105	84	52.5	42	31.5	27	33.92	129.6	86.4	324.74	175-637.5
Actual coverage, length x width (mm)	1200 x 500						1250 x 600						1170 x 360					
Square metres per sheet (m ²)	0.6						0.75						0.45	0.72		0.51	2.50	
Weight per pallet (kg)	190						490						210	450		540	700	
Density (kg/m ³)	~ 130						~ 140						~ 130	~ 160		~ 260	~ 250	
Nominal thermal resistivity R _D (m ² K/W)	0.50	1.00	1.25	1.50	2.05	2.55	0.50	0.75	1.00	1.50	2.05	2.55	3.05	1.05	0.50	0.75	0.10	0.10-0.35
Thermal resistivity R (m ² K/W)	0.45	0.95	1.20	1.45	1.95	2.40	0.45	0.70	0.95	1.40	1.90	2.35	2.85	1.00	0.50	0.70	0.10	0.10-0.35
sd-value (m)	0.06	0.12	0.15	0.18	0.24	0.3	0.06	0.09	0.12	0.18	0.24	0.30	0.36	0.12	0.11	0.16	0.03	0.03-0.09
Vapour diffusion factor (μ)	3						3						3	5		5	5	
Specific heat capacity (J/kgK)	2100						2100						2100	2100		2100	2100	
Nominal thermal conductivity λ _D (W/mK)	0.039						0.039						0.039	0.040		0.046	0.046	
Thermal conductivity λ̄ (W/mK) as per German reg.	0.041						0.042						0.041	0.042		0.048	0.048	
Compressive stress/ strength (kPa)	50						70									100	100	
Tensile strength perpendicular to board surface (kPa)	7.5																	
Short-term water absorption (kg/m ²)																≤ 2.0	≤ 2.0	
Dynamic stiffness (MN/m)													50	30				
Compressibility (mm)													2	2				
Air flow resistivity (kPa·s/m ²)	100						100						100	100		100	100	
Fire reaction 1)	E						E						E	E		E	E	

Product	Thermowall®																				Thermowall® NF	Thermowall®-gf ³⁾										
Joint Type	Butt										Tongue and Groove										Tongue and Groove	Tongue and Groove						Butt				
	DIN EN 13171																					DIN EN 13171										
Thickness (mm)	20	40	60	80	100	120	140	160	180	80	100	120	80	100	120	80	100	120	140	160	60	40	60	60	60	60	40	60	40	60	60	
Length x width (mm)	1250x590					830x600					2600x1250					2800x1250					1300x600					1800x600	1300x600	1800x600	2576x1176	2600x1250	2800x1250	3000x1250
Weight per sheet (kg)	2.4	4.7	7.1	9.4	8.0	9.6	11.2	12.7	14.3	41.6	52.0	62.4	44.8	56.0	67.2	10.0	12.5	15.0	17.5	20.0	10.4	5.7	8.66	11.95	33.6	24.05	36.08	25.9	38.85	41.63		
Weight per m ² (kg)	3.2	6.4	9.6	12.8	16.0	19.2	22.4	25.6	28.8	12.8	16.0	19.2	12.8	16.0	19.2	12.8	16.0	19.2	22.4	25.6	9.6	7.4	11.1	11.1	11.1	7.4	11.1	7.4	11.1	11.1		
Boards per pallet	224	112	70	56	42	32	28	24	24	12	9	8	12	9	8	54	44	36	32	28	34	108	72	34	16	24	15	24	15	15		
Square metres per pallet (m ²)	165.2	82.6	51.63	41.3	20.92	15.94	13.94	11.95	11.95	39.00	42.00	29.25	31.50	26.00	28.00	42.12	34.32	28.08	24.96	21.84	36.72	84.24	56.16	36.72	48.47	78.00	48.75	84.00	52.50	56.25		
Actual coverage, length x width (mm)											1276x576					1280x580					1780x580	1276x576	1776x576	2552x1152								
Square metres per sheet (m ²)	0.738					0.498					3.25	3.25	3.25	3.5	3.5	3.5	0.78					1.08	0.78	1.08	3.03	3.25	3.5	3.75				
Weight per pallet (kg)	540					320					520	520	520	560	560	560	540					345	650	460	640	610	570	650	610	730		
Density (kg/m ³)	~ 160																				~ 160	~ 185										
Nominal thermal resistivity R _D (m ² K/W)	0.50	1.00	1.50	2.00	2.50	3.00	3.50	4.00	4.60	2.00	2.50	3.00	2.00	2.50	3.00	2.00	2.50	3.00	3.50	4.00	1.50	0.90	1.35	1.35	1.35	0.90	1.35	0.90	1.35	1.35		
Thermal resistivity R (m ² K/W)	0.45	0.95	1.40	1.90	2.35	2.85	3.30	3.80	4.25	1.90	2.35	2.85	1.90	2.35	2.85	1.90	2.35	2.85	3.30	3.80	1.40	0.85	1.30	1.30	1.30	0.85	1.30	0.85	1.30	1.30		
sd-value (m)	0.08	0.16	0.24	0.32	0.40	0.48	0.56	0.64	0.54	0.32	0.40	0.48	0.32	0.40	0.48	0.32	0.40	0.48	0.46	0.64	0.24	0.12	0.18	0.18	0.18	0.12	0.18	0.12	0.18	0.18		
Vapour diffusion factor (μ)	4																				4	3										
Specific heat capacity (J/kgK)	2100																				2100	2100										
Nominal thermal conductivity λ _D (W/mK)	0.040																				0.040	0.043										
Thermal conductivity λ (W/mK) as per German reg.	0.042																				0.042	0.045										
Compressive stress/ strength (kPa)	100																				100	≥ 150										
Tensile strength perpendicular to board surface (kPa)	10																				10	20										
Short-term water absorption (kg/m ²)	≤ 1.0																				≤ 1.0	≤ 1.0										
Dynamic stiffness (MN/m)																																
Compressibility (mm)																																
Air flow resistivity (kPa·s/m ²)	100																				100	100										
Fire reaction 1)	E																				E	E										

Product	Thermowall®-L ⁴⁾					Pyroresist® wall			
Joint Type	Butt					Tongue and Groove			
	DIN EN 13171					DIN EN 13171			
Thickness (mm)	120	140	160	180	200	60	80	100	120
Length x width (mm)	1250 x 590					1800 x 600 ⁵⁾			
Weight per sheet (kg)	9.74	11.36	12.98	14.6	16.23	12	16	20	24
Weight per m ² (kg)	13.2	15.4	17.6	19.8	22.00	11.10	14.80	18.50	22.20
Boards per pallet	36	32	28	24	22	36	26	22	18
Square metres per pallet (m ²)	26.55	23.6	20.65	17.7	16.23	38.88	28.08	23.76	19.44
Actual coverage, length x width (mm)						1780 x 580			
Square metres per sheet (m ²)	0.738					1.08			
Weight per pallet (kg)	370					460			
Density (kg/m ³)	~ 110					190			
Nominal thermal resistivity R _D (m ² K/W)	3.15	3.65	4.2	4.7	5.25	1.35	1.85	2.30	2.75
Thermal resistivity R (m ² K/W)	3	3.5	4	4.5	5.0	1.30	1.75	2.20	2.65
sd-value (m)	0.36	0.42	0.48	0.54	0.60	0.24	0.32	0.40	0.48
Vapour diffusion factor (μ)	3					4			
Specific heat capacity (J/kgK)	2100					2100			
Nominal thermal conductivity λ _D (W/mK)	0.038					0.043			
Thermal conductivity λ̄ (W/mK) as per German reg.	0.040					0.045			
Compressive stress/ strength (kPa)	50					150			
Tensile strength perpendicular to board surface (kPa)	7.5					10			
Short-term water absorption (kg/m ²)	≤ 1.0					≤ 1.0			
Dynamic stiffness (MN/m)									
Compressibility (mm)									
Air flow resistivity (kPa·s/m ²)	100					150			
Fire reaction ¹⁾	E					C-s1, d0 ⁴⁾			

- › The thermal resistivity is based on λ_{90/90} and board thickness
- › GUTEX Multiplex-top® and GUTEX Ultratherm®: Guaranteed by Germany's Association of Roofers
- › GUTEX will be glad to send you test reports

¹⁾ Euro class as per DIN EN 13501-1

²⁾ Other dimensions available by request

³⁾ Suitable for REI 90 compliance-tested structures.

⁴⁾ Certification pending

⁵⁾ Custom sizes are available; consult factory or sales agent
Non-smouldering PB-Hoch-180895 as per EN 16733



GUTEX

ADVANTAGES



Pleasant indoor climate



Ideal acoustic insulation



Insulation in summer



Insulation in winter



Systems deliver greater dependability



Sustainability



Service

Certified quality

All GUTEX products are manufactured from fir and spruce obtained solely from the Black Forest using sustainable forestry practices – truly the best basis for high quality wood fibre insulation. In addition, the natureplus® certificate indicates the product is biologically safe and manufactured using environmentally safe techniques and practices. It also verifies its suitability and usability for the specified applications.



OUR PRODUCT AND SERVICE DESIGNATIONS



Roof



Wall



Interior

Your stockist / Advisor:



Ecological Building Systems

For full technical support for your project, please contact Ecological Building Systems at info@EcologicalBuildingSystems.com or visit www.EcologicalBuildingSystems.com

Ireland: 046 9432104
Fax: 046 9432435

UK: 01228 711 511
Fax: 01228 712 280



GUTEX Holzfaserplattenwerk

Gutenberg 5 | D-79761 Waldshut-Tiengen, Germany

Phone: + 49 7741/6099-0 | www.gutex.de | info@gutex.de

*Knowing you've
done the right thing,
getroffen zu haben. Das
GUTEX effect.*



THE
GUTEX
EFFECT

All rights reserved. The information provided herein is subject to change. Although all of the information was current at the time of its publication, the publication of superseding information renders the old information invalid. Henseleimann GmbH + Co KG is not liable for any damage resulting from error or misprinting. The suitability of the products for applications not specified in this brochure is not guaranteed. Warranty and liability claims are subject to the terms of GUTEX's General Terms of Business.