

# CERTIFICATE

Certified Passive House Component

Component-ID 2325wm03 valid until 31st December 2025

Passive House Institute  
Dr. Wolfgang Feist  
64283 Darmstadt  
Germany

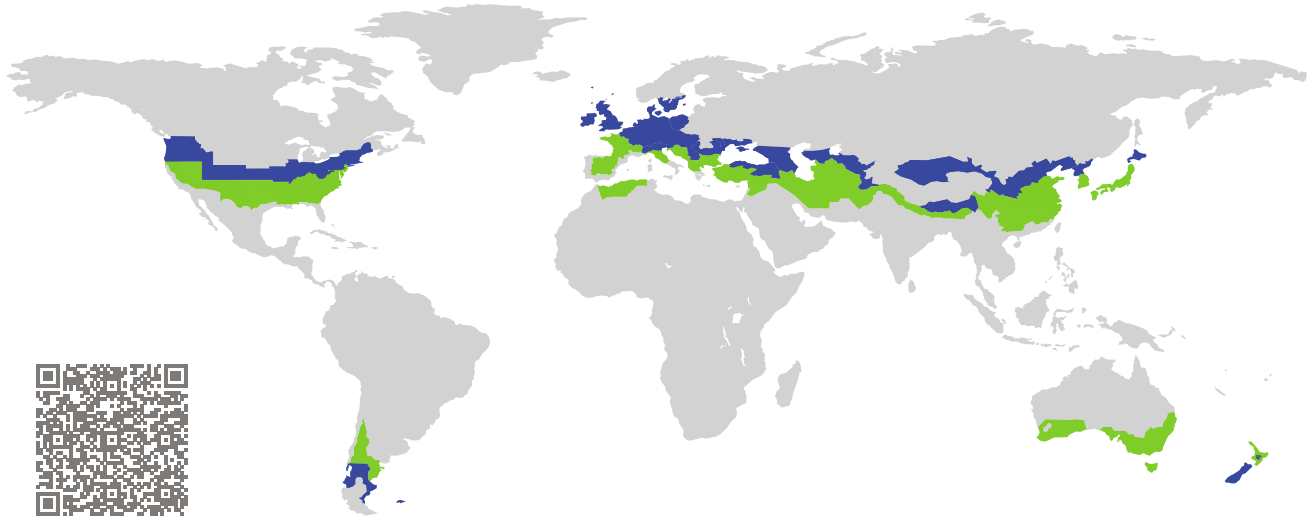

Category: **Window mounting system**  
Manufacturer: **BOSIG Baukunststoffe GmbH,  
Elsterwerda,  
Germany**  
Product name: **Phonotherm®**

**This certificate was awarded based on the following  
criteria for the cool, temperate climate zone**

Efficiency  $\Delta U \leq 0.05 \text{ W}/(\text{m}^2 \cdot \text{K})$

Hygiene  $f_{\text{Rsi} = 0.25} \geq 0.70$



cool, temperate climate



**CERTIFIED  
COMPONENT**

Passive House Institute

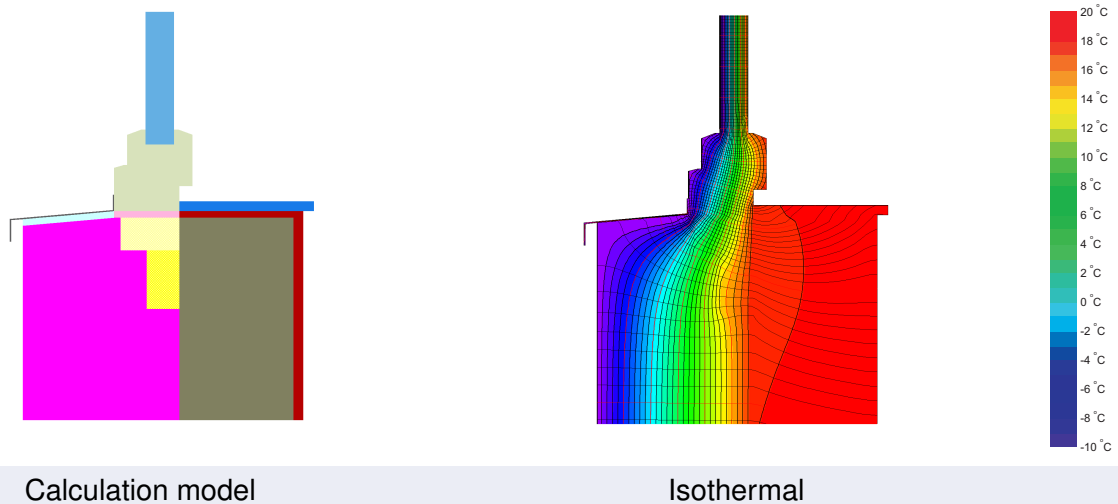

## Description

Window installation system made of PUR rigid foam (0.083 W/(m K)), used as a base profile in the wall plane or as a facade installation system with adhesive and screws according to the manufacturer's specifications. Heat losses through the screws were determined by 3D heat flow simulation. The effective thermal conductivity with screws is 0.0867 W/(m K).

## Explanation

The certifiability is demonstrated by the increase of the heat transfer coefficient  $\Delta U$  [W/(m<sup>2</sup>.K)] caused by the installation thermal bridge (efficiency criterion) in conjunction with given installation situations and window frames as well as by the minimum temperature factor at the coldest point of the installation connection (hygiene criterion).

The heat transfer coefficients (U-values) and the thermal bridge loss coefficients ( $\psi$ -values) of the window are determined on the basis of DIN EN ISO 10077-2, the installation thermal bridges according to ISO 10211.

The Passive House Institute has defined international component criteria for seven climate zones. In principle, components which have been certified for climate zones with higher requirements may also be used in climates with less stringent requirements. In a particular climate zone it may make sense to use a component of a higher thermal quality which has been certified for a climate zone with more stringent requirements.



Further information relating to certification can be found on [www.passivehouse.com](http://www.passivehouse.com) and [passipedia.org](http://passipedia.org).

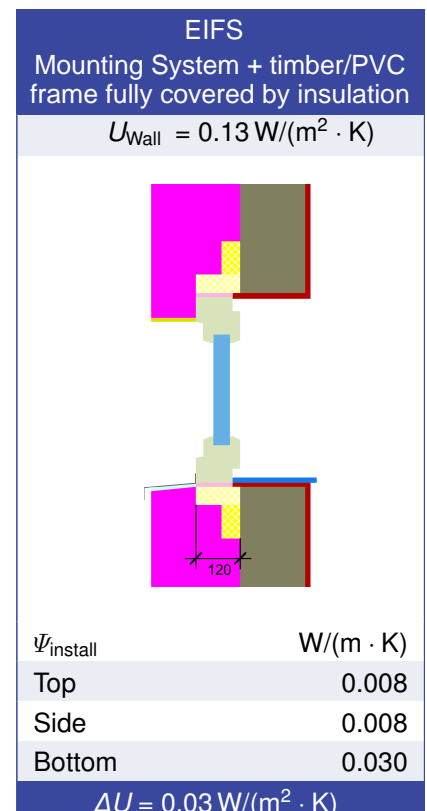
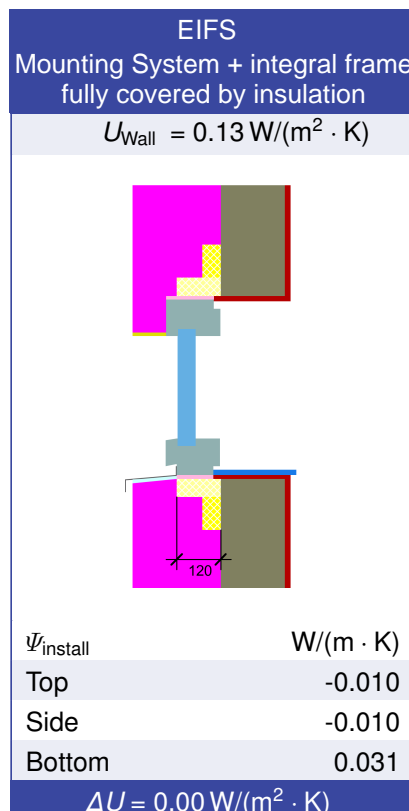
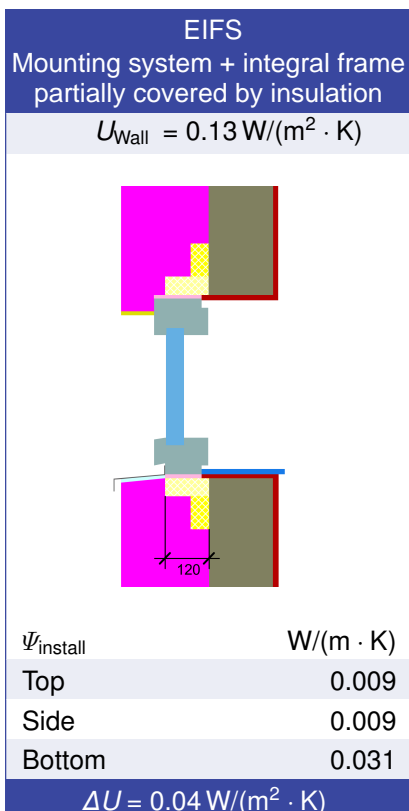
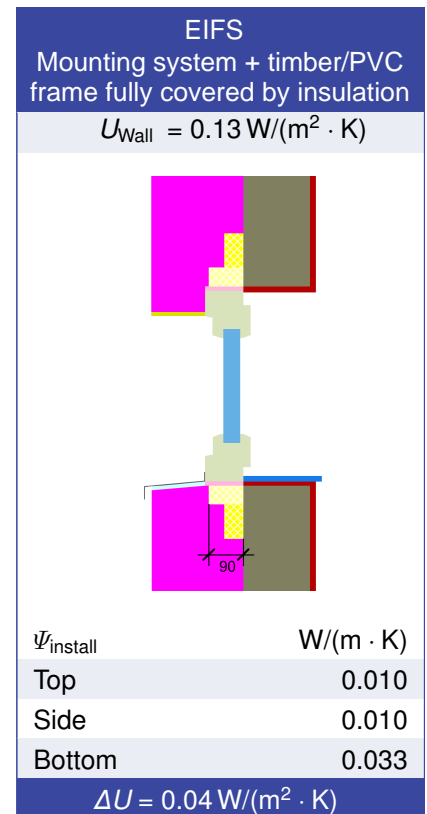
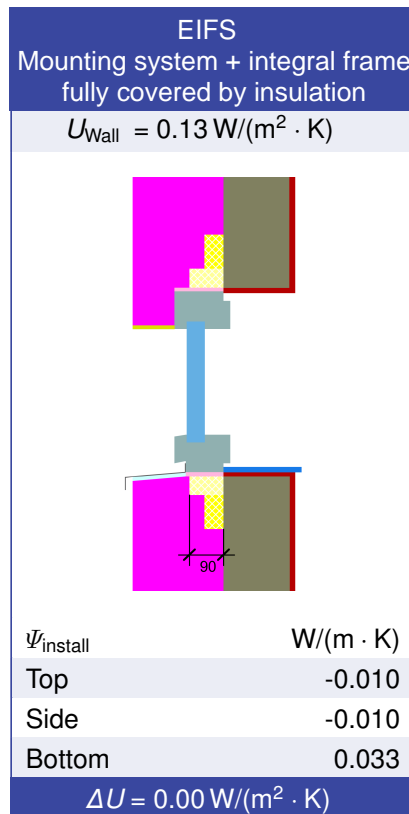
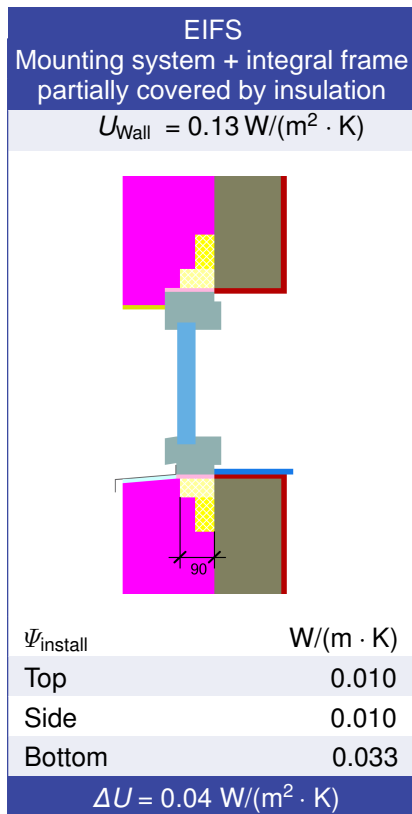

## Validated installations

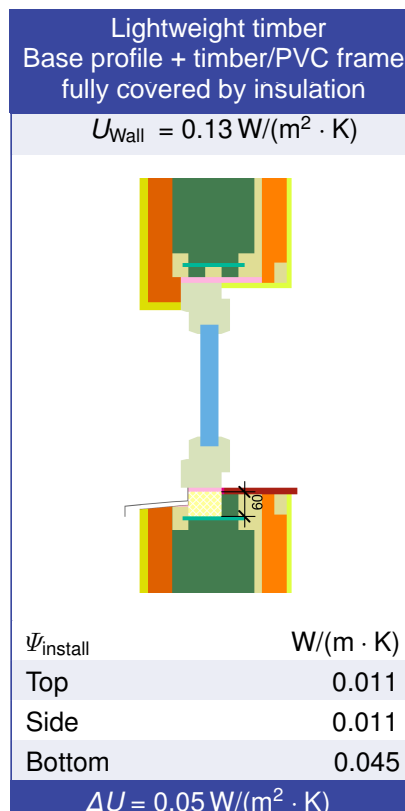
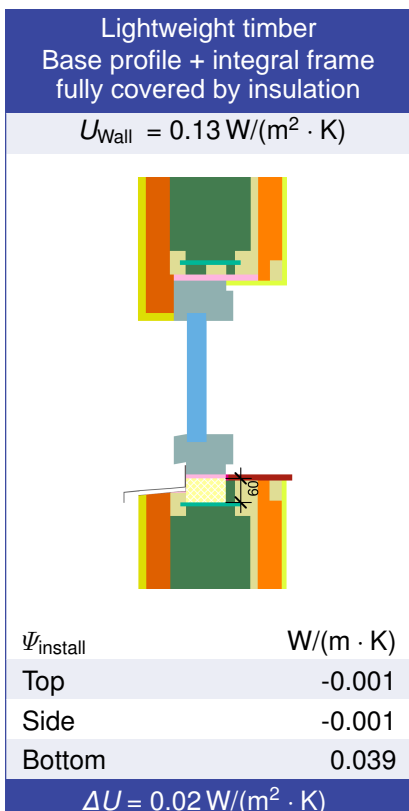
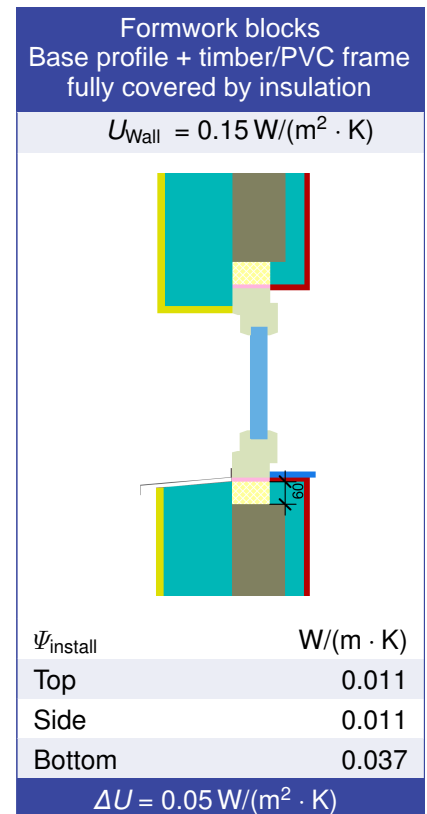
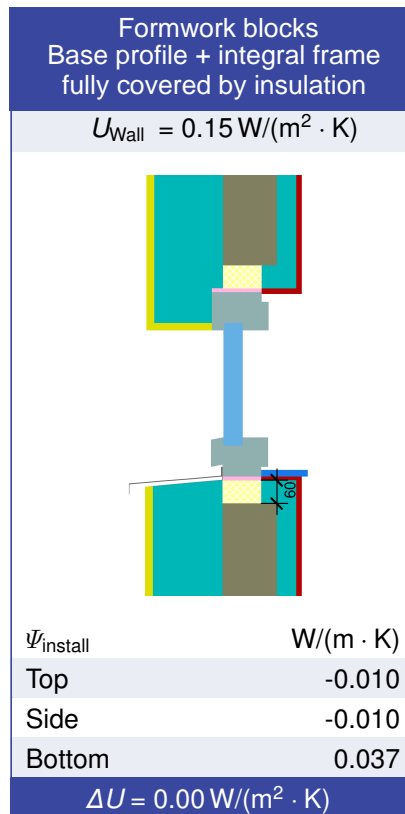
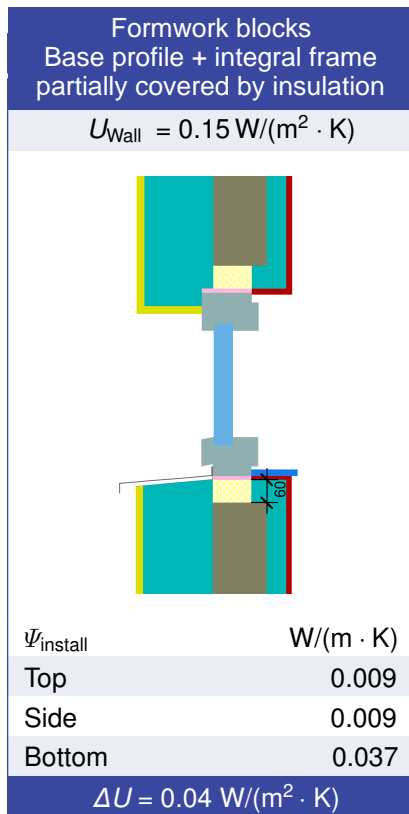

## Validated installations



Integral Frame values			Frame width $b_f$ mm	$U$ -value frame $U_f$ W/(m <sup>2</sup> · K)	$\Psi$ -glazing edge $\Psi_g$ W/(m · K)	Temp. Factor $f_{Rsi=0.25}$ [-]
Bottom	(OB1)		100	0.90	0.026	0.70
Top	(OH1)		100	0.79	0.026	0.70
Lateral	(OJ1)		100	0.79	0.026	0.70
			Spacer: PHI phA-Spacer      Secondary seal: Polysulfide			

Timber/PVC Frame values			Frame width $b_f$ mm	$U$ -value frame $U_f$ W/(m <sup>2</sup> · K)	$\Psi$ -glazing edge $\Psi_g$ W/(m · K)	Temp. Factor $f_{Rsi=0.25}$ [-]
Bottom	(OB1)		125	0.73	0.036	0.70
Top	(OH1)		125	0.73	0.036	0.70
Lateral	(OJ1)		125	0.73	0.036	0.70
			Spacer: PHI phB-Spacer      Secondary seal: Polysulfide			



---

For over 20 years, Ecological Building Systems has been at the forefront of environmental and sustainable building products supplying a range of innovative airtightness solutions and natural insulations backed up with expert technical support.

**As product suppliers in the UK and Ireland, we're happy to assist you with your projects and have expert technical and sales advice on hand.**



**Call us**

**Great Britain** +44 (0)1228 711511

**Ireland** +353 46 9432104



**Email us**

[info@ecologicalbuildingsystems.com](mailto:info@ecologicalbuildingsystems.com)



**Find us**

**Great Britain** Ecological Building Systems UK Ltd.,  
Cardewlees, Carlisle, Cumbria, CA5 6LF,  
United Kingdom

**Ireland** Ecological Building Systems Ltd.,  
Main Street, Athboy. Co. Meath, C15 Y678,  
Republic of Ireland